

Losmandy AZ8: Encoders Installation

Please unpack all parts from the encoder kit. Make sure that your kit contains the following parts:



Encoder resolution: 311296 steps
Current consumption: 20 mA each

This instruction booklet shows the installation procedure for one encoder. The installation procedure for the second encoder is identical.

Tools required:

- Allen key (supplied)
- Philips head screw driver (not supplied)



Do not subject encoder disks to magnetic fields as it may affect the magnetization of the magnetic multi-pole rings.

Altitude encoder installation

1. Start with removing the dovetail on the side with the clutch adjustment knob – only the central socket head screw needs to be removed:

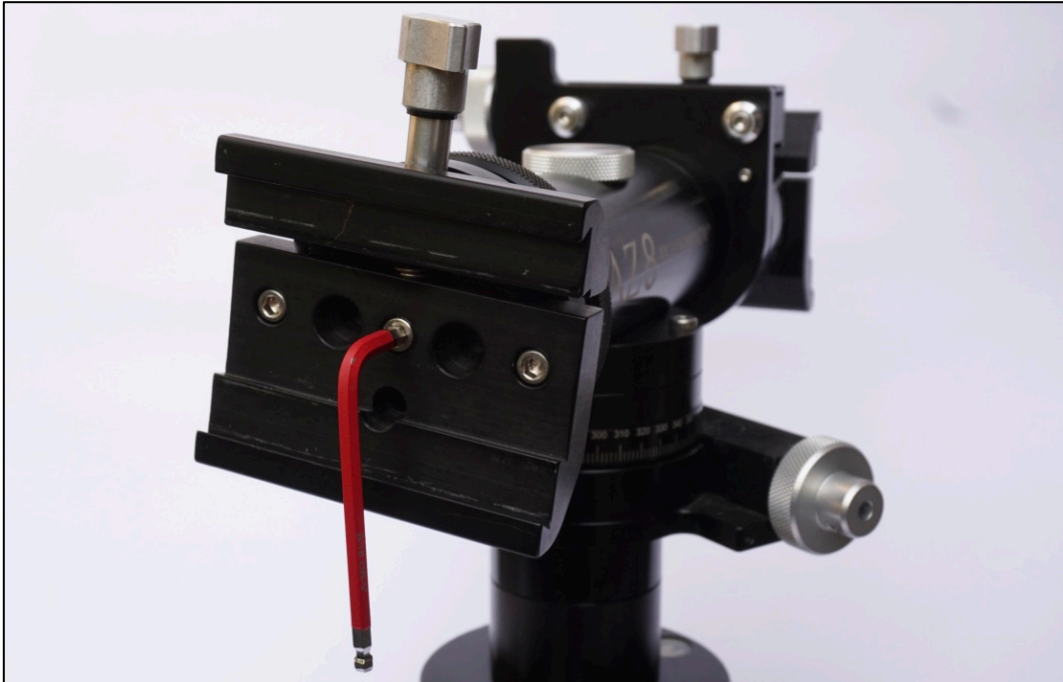

2. Remove the clutch knob, wavy washer and spacer – you will not need the washer and the spacer:



3. Install the encoder reader clamp – slide it over the end and push it all the way in:



4. Tighten the screw:

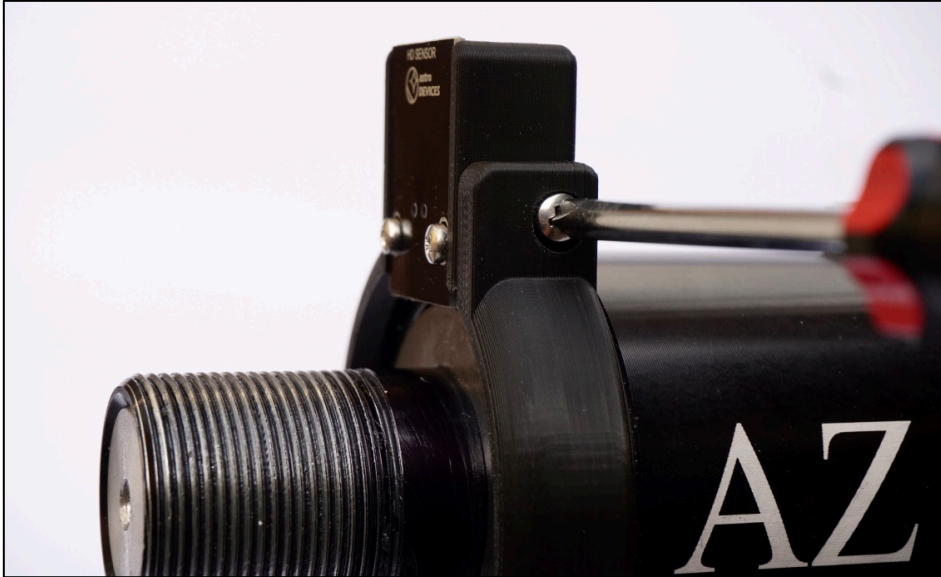

5. Install the encoder ring:



6. Push the ring all the way in:



7. Then install six pins into the encoder ring:



8. Then slide a washer, thrust bearing and another washer onto the shaft:



9. Tighten three set screws:



Make sure that you do not over-tighten the set screws as this will lead to a deformation of the disk resulting in reduced accuracy.

10. Install clutch knob:





11. Install the dovetail:



All done for the altitude.

Azimuth encoder

It is a little bit easier to install the azimuth encoder. Please follows the same procedure as for the altitude encoder:

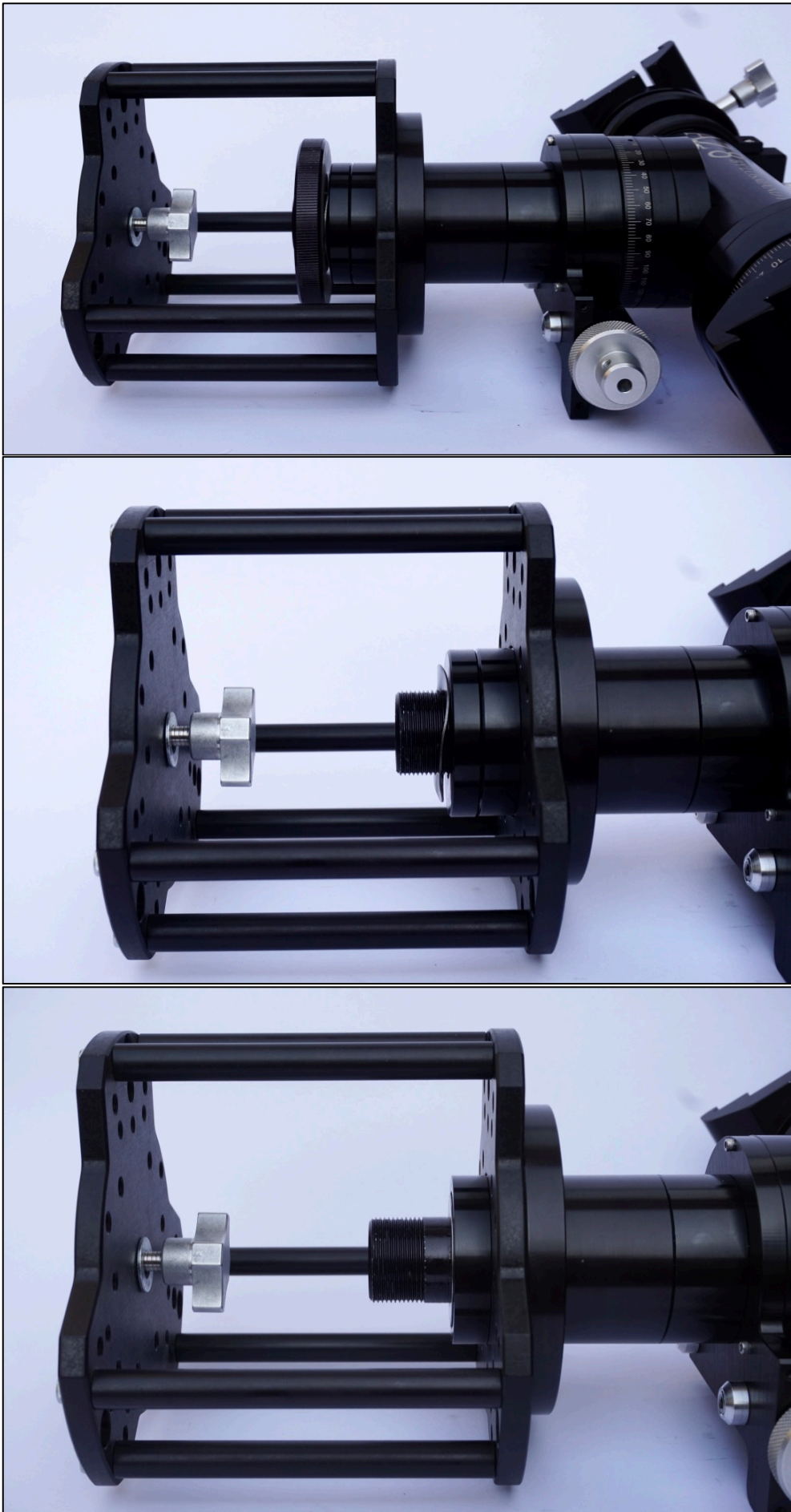

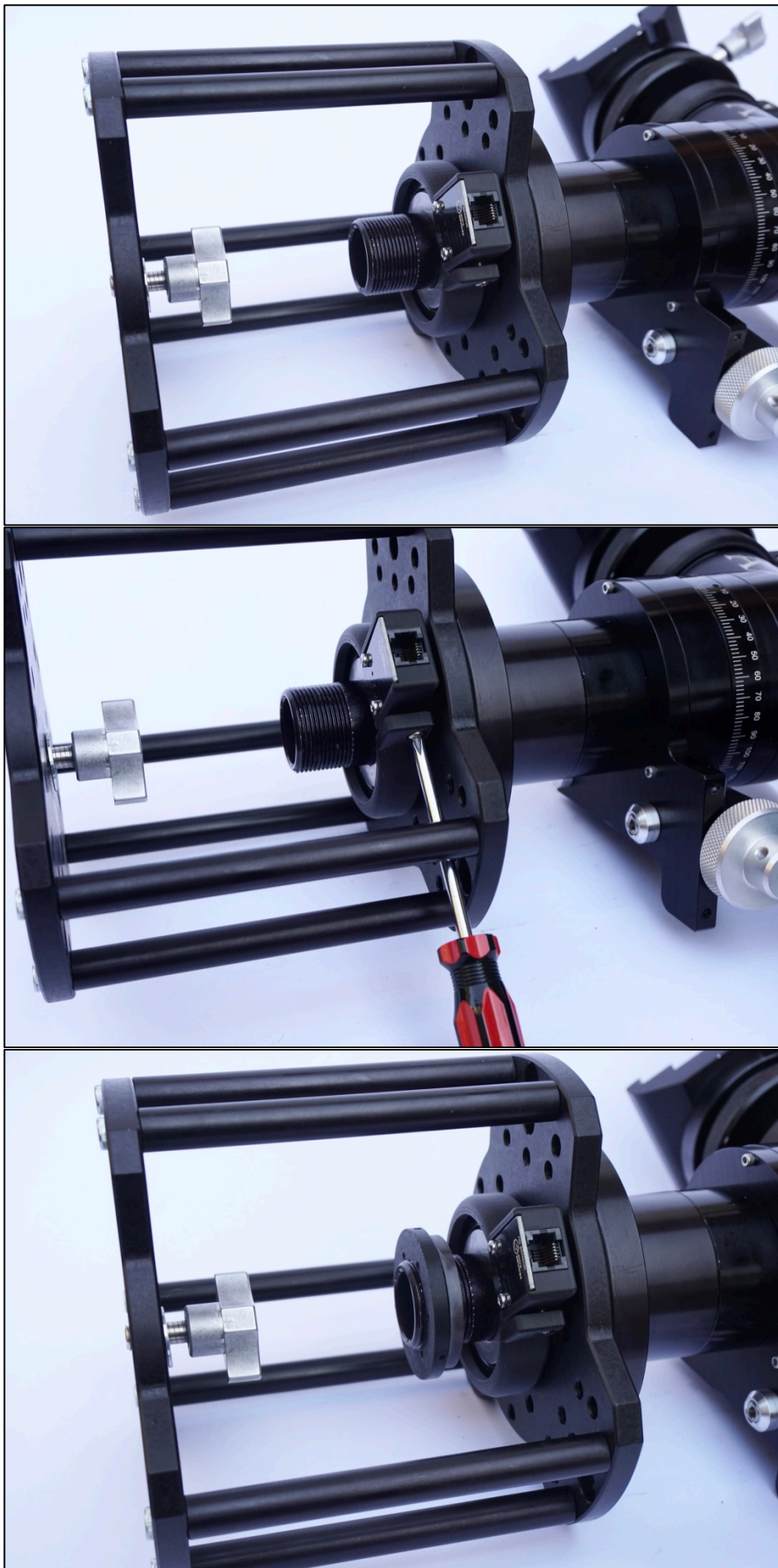

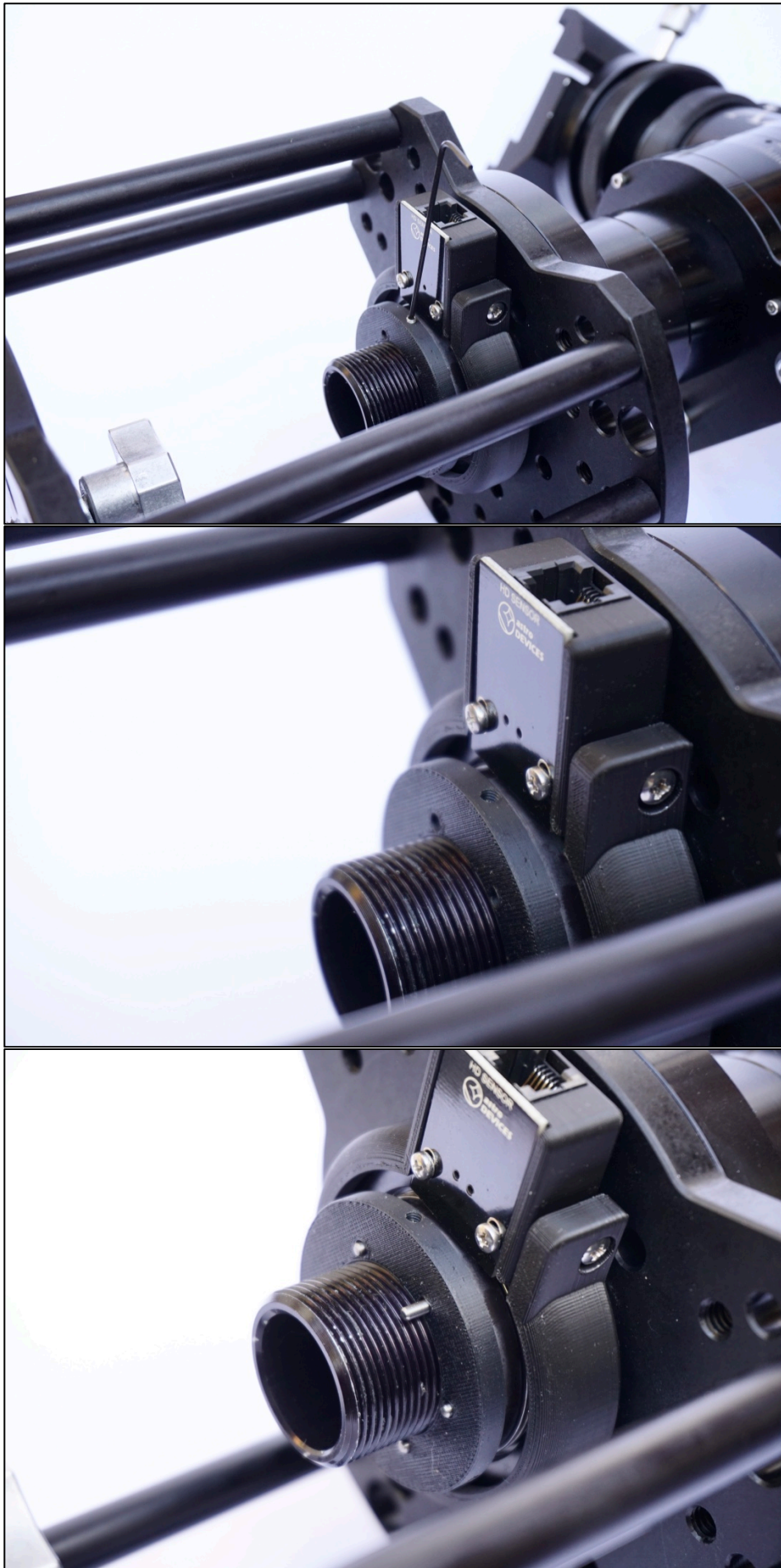

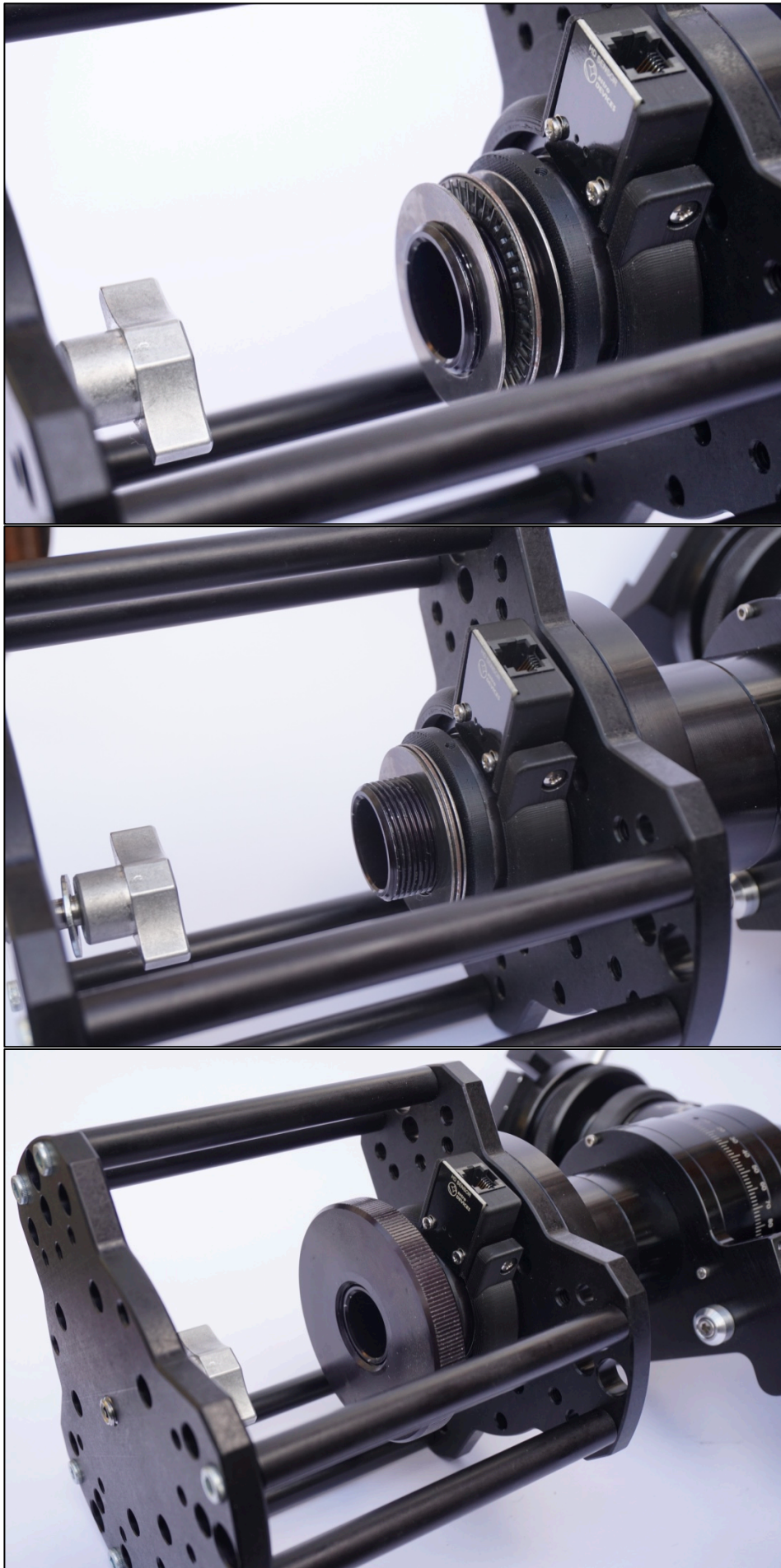

Finished!

Copyright © 2016-2018, Astro Devices. All rights reserved.

Now insert the encoder cable and connect it to your DSC.



Please do not forget to set the encoder steps in your DSC to 311296!

Enjoy!